

06 ELECTRICAL PLAN
SCALE: 1/4"=1'-0"

ELECTRICAL LEGEND	
⊕	SWITCH
⊕ ³	3-WAY SWITCH
⊕ ^{110V}	110V RECEPTACLE
⊕ ^{GFCI}	GFCI
⊕ ^{WP}	GROUND FAULT CIRCUIT INTERRUPTER
⊕ ^{220V}	220V OUTLET
⊕ ^{INC}	CEILING MOUNTED INCANDESCENT OR FLUORESCENT LIGHT FIXTURE
⊕ ^{WALL}	WALL MOUNTED INCANDESCENT LIGHT FIXTURE
⊕ ^{DISC}	DISCONNECT
⊕ ^{JUN}	JUNCTION BOX
⊕ ^{THER}	THERMOSTAT
⊕ ^{SMOKE}	CEILING MOUNTED SMOKE DETECTOR
⊕ ^{FAN}	EXHAUST FAN / LIGHT COMBO

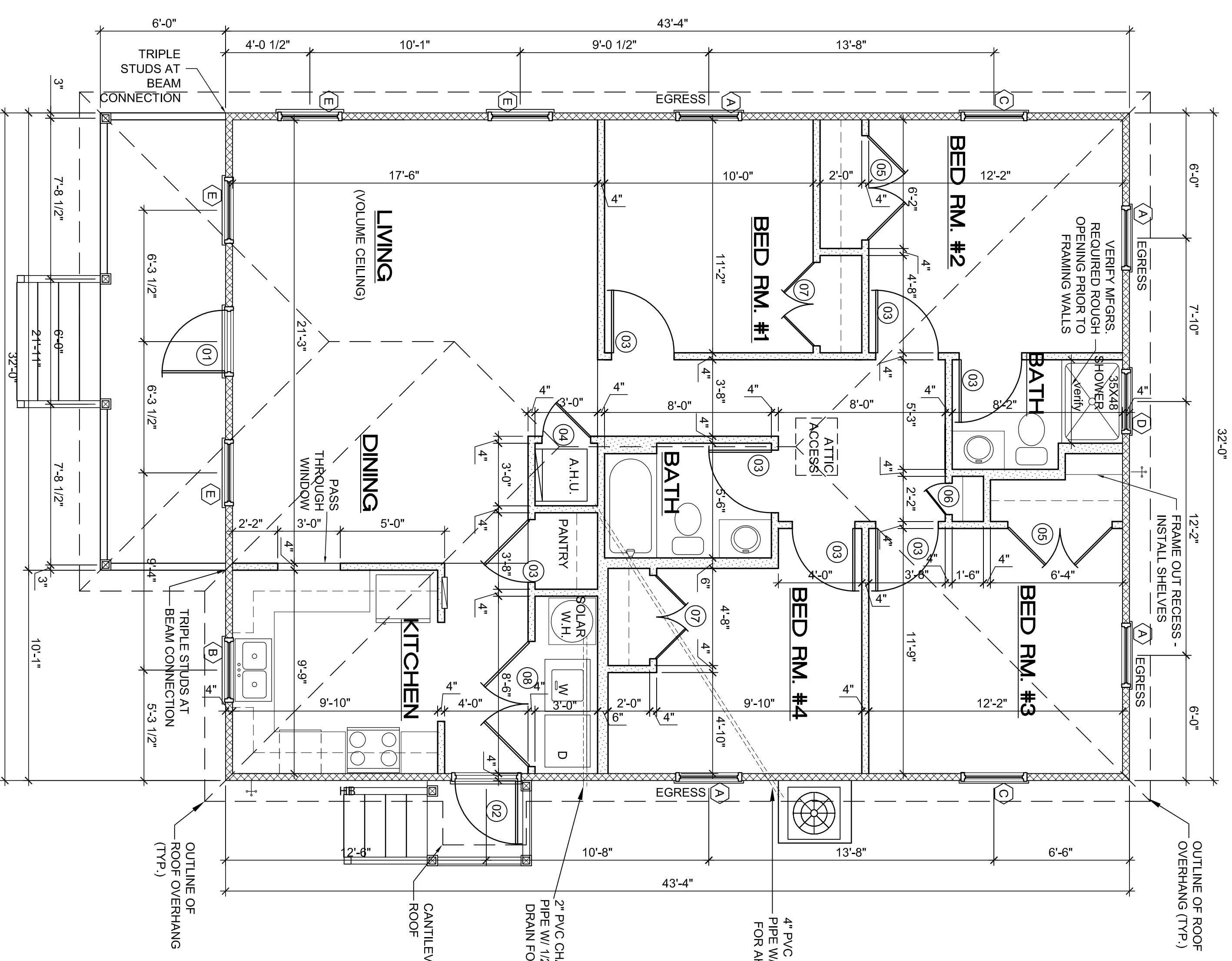

06 FLOOR PLAN
SCALE: 1/4"=1'-0"

AREA INFORMATION	
LIVING AREA U/A (4 BD/2 BA)	1,387 sq.ft.
1530 sq.ft. (incl. Lg. Area)	132 sq.ft.
PORCH / ENTRY	
TOTAL	1,519 sq.ft.

DOOR SCHEDULE	
(01) 3'-0" x 6'-6"	Exl. Metal Insulated
(02) 3'-0" x 6'-6"	Exl. Metal Insulated w/ glass
(03) 3'-0" x 6'-6"	Int. 6 Panel
(04) 2'-4" x 6'-6"	Int. 6 Panel
(05) 3'-0" x 6'-6"	Int. 6 Panel
(06) 3'-0" x 6'-6"	Int. 6 Panel
(07) 3'-0" x 6'-6"	Int. 6 Panel
(08) 3'-0" x 6'-6"	Int. 6 Panel
(09) 3'-0" x 6'-6"	Int. 6 Panel
(10) 3'-0" x 6'-6"	Int. 6 Panel
(11) 3'-0" x 6'-6"	Int. 6 Panel
(12) 3'-0" x 6'-6"	Int. 6 Panel
(13) 3'-0" x 6'-6"	Int. 6 Panel
(14) 3'-0" x 6'-6"	Int. 6 Panel
(15) 3'-0" x 6'-6"	Int. 6 Panel
(16) 3'-0" x 6'-6"	Int. 6 Panel
(17) 3'-0" x 6'-6"	Int. 6 Panel
(18) 3'-0" x 6'-6"	Int. 6 Panel
(19) 3'-0" x 6'-6"	Int. 6 Panel
(20) 3'-0" x 6'-6"	Int. 6 Panel
(21) 3'-0" x 6'-6"	Int. 6 Panel
(22) 3'-0" x 6'-6"	Int. 6 Panel
(23) 3'-0" x 6'-6"	Int. 6 Panel
(24) 3'-0" x 6'-6"	Int. 6 Panel
(25) 3'-0" x 6'-6"	Int. 6 Panel
(26) 3'-0" x 6'-6"	Int. 6 Panel
(27) 3'-0" x 6'-6"	Int. 6 Panel
(28) 3'-0" x 6'-6"	Int. 6 Panel
(29) 3'-0" x 6'-6"	Int. 6 Panel
(30) 3'-0" x 6'-6"	Int. 6 Panel
(31) 3'-0" x 6'-6"	Int. 6 Panel
(32) 3'-0" x 6'-6"	Int. 6 Panel
(33) 3'-0" x 6'-6"	Int. 6 Panel
(34) 3'-0" x 6'-6"	Int. 6 Panel
(35) 3'-0" x 6'-6"	Int. 6 Panel
(36) 3'-0" x 6'-6"	Int. 6 Panel
(37) 3'-0" x 6'-6"	Int. 6 Panel
(38) 3'-0" x 6'-6"	Int. 6 Panel
(39) 3'-0" x 6'-6"	Int. 6 Panel
(40) 3'-0" x 6'-6"	Int. 6 Panel
(41) 3'-0" x 6'-6"	Int. 6 Panel
(42) 3'-0" x 6'-6"	Int. 6 Panel
(43) 3'-0" x 6'-6"	Int. 6 Panel
(44) 3'-0" x 6'-6"	Int. 6 Panel
(45) 3'-0" x 6'-6"	Int. 6 Panel
(46) 3'-0" x 6'-6"	Int. 6 Panel
(47) 3'-0" x 6'-6"	Int. 6 Panel
(48) 3'-0" x 6'-6"	Int. 6 Panel
(49) 3'-0" x 6'-6"	Int. 6 Panel
(50) 3'-0" x 6'-6"	Int. 6 Panel
(51) 3'-0" x 6'-6"	Int. 6 Panel
(52) 3'-0" x 6'-6"	Int. 6 Panel
(53) 3'-0" x 6'-6"	Int. 6 Panel
(54) 3'-0" x 6'-6"	Int. 6 Panel
(55) 3'-0" x 6'-6"	Int. 6 Panel
(56) 3'-0" x 6'-6"	Int. 6 Panel
(57) 3'-0" x 6'-6"	Int. 6 Panel
(58) 3'-0" x 6'-6"	Int. 6 Panel
(59) 3'-0" x 6'-6"	Int. 6 Panel
(60) 3'-0" x 6'-6"	Int. 6 Panel
(61) 3'-0" x 6'-6"	Int. 6 Panel
(62) 3'-0" x 6'-6"	Int. 6 Panel
(63) 3'-0" x 6'-6"	Int. 6 Panel
(64) 3'-0" x 6'-6"	Int. 6 Panel
(65) 3'-0" x 6'-6"	Int. 6 Panel
(66) 3'-0" x 6'-6"	Int. 6 Panel
(67) 3'-0" x 6'-6"	Int. 6 Panel
(68) 3'-0" x 6'-6"	Int. 6 Panel
(69) 3'-0" x 6'-6"	Int. 6 Panel
(70) 3'-0" x 6'-6"	Int. 6 Panel
(71) 3'-0" x 6'-6"	Int. 6 Panel
(72) 3'-0" x 6'-6"	Int. 6 Panel
(73) 3'-0" x 6'-6"	Int. 6 Panel
(74) 3'-0" x 6'-6"	Int. 6 Panel
(75) 3'-0" x 6'-6"	Int. 6 Panel
(76) 3'-0" x 6'-6"	Int. 6 Panel
(77) 3'-0" x 6'-6"	Int. 6 Panel
(78) 3'-0" x 6'-6"	Int. 6 Panel
(79) 3'-0" x 6'-6"	Int. 6 Panel
(80) 3'-0" x 6'-6"	Int. 6 Panel
(81) 3'-0" x 6'-6"	Int. 6 Panel
(82) 3'-0" x 6'-6"	Int. 6 Panel
(83) 3'-0" x 6'-6"	Int. 6 Panel
(84) 3'-0" x 6'-6"	Int. 6 Panel
(85) 3'-0" x 6'-6"	Int. 6 Panel
(86) 3'-0" x 6'-6"	Int. 6 Panel
(87) 3'-0" x 6'-6"	Int. 6 Panel
(88) 3'-0" x 6'-6"	Int. 6 Panel
(89) 3'-0" x 6'-6"	Int. 6 Panel
(90) 3'-0" x 6'-6"	Int. 6 Panel
(91) 3'-0" x 6'-6"	Int. 6 Panel
(92) 3'-0" x 6'-6"	Int. 6 Panel
(93) 3'-0" x 6'-6"	Int. 6 Panel
(94) 3'-0" x 6'-6"	Int. 6 Panel
(95) 3'-0" x 6'-6"	Int. 6 Panel
(96) 3'-0" x 6'-6"	Int. 6 Panel
(97) 3'-0" x 6'-6"	Int. 6 Panel
(98) 3'-0" x 6'-6"	Int. 6 Panel
(99) 3'-0" x 6'-6"	Int. 6 Panel
(100) 3'-0" x 6'-6"	Int. 6 Panel

WINDOW SCHEDULE	
A) SH25	RO. 36 1/2" X 62 1/2"
B) SH23	RO. 36 1/2" X 37 7/8"
C) HR22	RO. 36 1/4" X 25 1/4"
D) SH2	RO. 36 1/2" X 25 1/4"
E) SH24	RO. 36 1/2" X 50 1/8"
F) SH34	NOT USED

NOTES
2-10x6 STAMP GRILLS ABOVE EACH BEDROOM DOOR FOR VENTILATION WHERE REQUIRED BY CODE. IN ADDITION, UNDERCUT EACH DOOR BY ONE INCH.
DIRECT SOLAR WATER HEATING SYSTEM BY OTHERS. SMALL PHOTO-VOLTAIC PANEL AND DC PUMP.

